

DOCUMENT 00 90 00
ADDENDUM

ADDENDUM NO. [3] **Date: March 12, 2019**

RE: **LACRESCENT-HOKAH PUBLIC SCHOOLS**
HIGH SCHOOL PARTIAL REROOF
1301 LANCER BLVD
LA CRESCENT, MINNESOTA 55947
HSR 18068

FROM: HSR Associates, Inc
100 Milwaukee Street
La Crosse, WI 54603
(608) 784-1830

To: Prospective Bidders

This addendum forms a part of the Contract Documents and modifies the original Bidding Documents dated February 2019. Acknowledge receipt of this Addendum in the space provided on the bid form. Failure to do so may subject the Bidder to disqualification.

This Addendum consists of [1] page and [3] 30 x 42 Drawings.

CHANGES TO DRAWINGS

1. Sheet A120R OVERALL ROOF PLANS 30 x 42 attached hereto
 - a. Dimensions added to plan for both segments.
2. Sheet 121R ROOF PLAN (SECTION A) 30 x 42 attached hereto
 - a. Plans are not to scale. Dimensions included on A120R.
3. Sheet 121R ROOF PLAN (SECTION B) 30 x 42 attached hereto
 - a. Plans are not to scale. Dimensions included on A120R

END OF DOCUMENT 00 90 00

Page Intentionally Left Blank

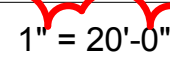

ADDED REFERENCE DIMENSIONS

~~A3~~



Consultant:

Project Title: **LA CRESCENT-HOKAH PUBLIC SCHOOLS
LA CRESCENT HIGH SCHOOL PARTIAL REROOF**
Project Location: **1301 LANCER BLVD
LA CRESCENT, MN. 55947**
Sheet Title: **ROOF PLAN (SECTION A)**

Project Number: **18068**

Project Date: **02-21-19**

Drawn By: **HLH**

Key Plan:

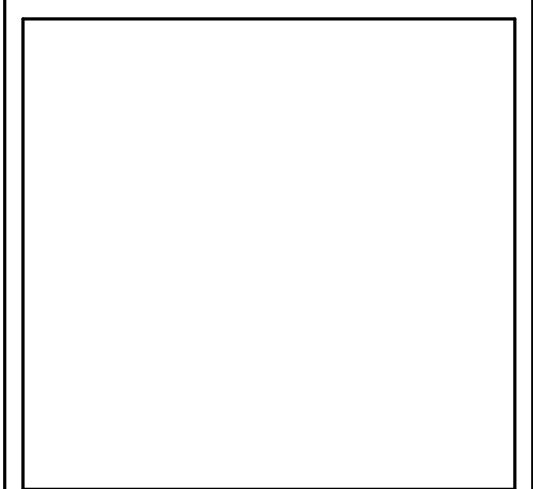
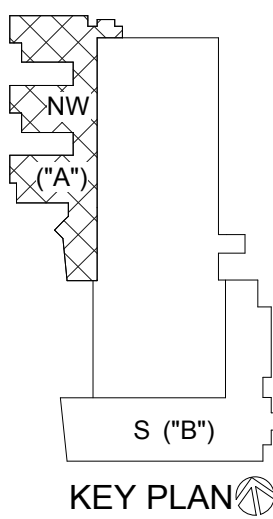

No.	Description	Date
A3	ADDENDUM 3	03-12-19

Graphic Scale: **VARIES**

Last Update: **3/12/2019 1:39:42 PM**

A121R

KEY NOTES ROOF	
1	EXISTING ROOF ACCESS HATCH 20A500
2	EXISTING 24" X 24" WALKING PAVERS: SALVAGE TO REINSTALL OVER MEMBRANE
3	EXISTING ROOF TOP HVAC UNIT CURB DETAIL 3A500
4	EXISTING SMOKE HATCH: REMOVE TERM BAR AND MEMBRANE FLASHING. INSTALL NEW MEMBRANE FLASHING AND CONT. TERM BAR AROUND HATCH
5	SHINGLED HIP ROOF: REMOVE SHINGLES. INSTALL WATERPROOF MEMBRANE AND SHINGLES. MAINTAIN EXISTING ROOF EDGE, FASCIA, AND FLASHINGS
6	REMOVE BALLAST, MEMBRANE, AND PARAPET COPING FLASHING AT AREAS RECEIVING NEW MEMBRANE. INSTALL FULLY ADHERED SINGLE MEMBRANE OVER NEW 1.5" MECHANICALLY ATTACHED POLYISOCYANURATE INSULATION OVER THE EXISTING 4" OF EPS INSULATION. (COVER BOARD REQUIRED FOR 30 YEAR ALTERNATE). TAPERED INSULATION INDICATED BY HATCHED AREAS.
7	SALVAGE AND REINSTALL SPLASH BLOCKS AT DOWNSPOUT
8	SHEET METAL CURB CAP
9	NEW CONCRETE SPLASH BLOCKS
10	REMOVE EXISTING SMOKE HATCH: RAISE HATCH ROOF CURB BY MINIMUM OF 6 INCHES. FLASH AND REINSTALL HATCH AND PAINT. COORDINATE ELECTRICAL AND FIRE ALARM DISCONNECT/RECONNECT.
11	PAINT EXISTING GAS PIPING. COVER ROOF SUPPORTS TO PROJECT FROM PAINT DRIPPING.
12	AT ALL ROOF TOP UNITS/ MECHANICAL EQUIPMENT RAISE ROOF CURB BY MINIMUM OF 3 INCHES. ROOFING CONTRACTOR TO CONTRACT DIRECTLY WITH MECHANICAL AND ELECTRICAL CONTRACTOR FOR DISCONNECT AND RECONNECT HVAC EQUIPMENT THAT IS REMOVED FROM CURB. DISTRICT HAS EXISTING RELATIONSHIP WITH ADVANCED COMFORT SPECIALISTS, LLC. CONTACT TOM LEE 608-783-2268
13	NEW PREFINISHED METAL CAP FLASHING AROUND ENTIRE PERIMETER OF RE-ROOF AREA. REFERENCE SECTION CUT DETAILS.
14	ADD ADDITIONAL 1/2" PER FOOT TAPERED INSULATION IN HIGHLIGHTED AREA TO IMPROVE DRAINAGE
15	REINSTALL EXISTING ROOF ACCESS LADDER

GENERAL ROOF NOTES:	
A	SEE ROOF SYSTEM NOTES FOR MINIMUM AND AVERAGE INSULATION VALUES.
B	ROOF EQUIPMENT SHOWN IS GRAPHIC ONLY. FIELD VERIFY CONDITIONS.
C	ALL METAL ROOF AND FLASHING, SHALL MEET CURRENT SMACNA REQUIREMENTS AND MANUFACTURER'S SPECIFIED WARRANTY.
D	WHERE MEMBRANE IS SHOWN OVER TOP OF WALL, EXTEND DOWN OPPOSITE SIDE AND SECURE TO BLOCKING.
E	TOP OF WALL BLOCKING SHOWN IS GRAPHIC. PROVIDE BLOCKING THAT SHALL BE ANCHORED TO WALL BELOW AS RECOMMENDED BY ROOFING SYSTEM MANUFACTURER TO WITHSTAND WIND UPLIFT AS STATED IN CODE. TOP OF WALLS SHALL SLOPE TOWARDS ROOF.
F	INSTALL BOND BREAK BETWEEN ALL WOOD BLOCKING AND CMU OR CONCRETE.
G	PROTECT, LAWN, PAVEMENT, AND ALL OTHER EXISTING SITE CONDITIONS. CONTRACTOR RESPONSIBLE FOR ANY DAMAGE TO THESE ITEMS.

ROOF EQUIPMENT LEGEND:	
CONTRACTOR TO VERIFY ALL EXISTING ROOF PENETRATIONS	
	EXISTING EXHAUST/ INTAKE VENT HOOD/ HVAC UNIT
	EXISTING AIR INTAKE/EXHAUST VENT/ PLUMBING VENT
	RD = EXISTING ROOF DRAIN
	EXISTING TAPERED INSULATION AREAS
	OS EXISTING OVERFLOW SCUPPER
	J.B. JOIST BEARING

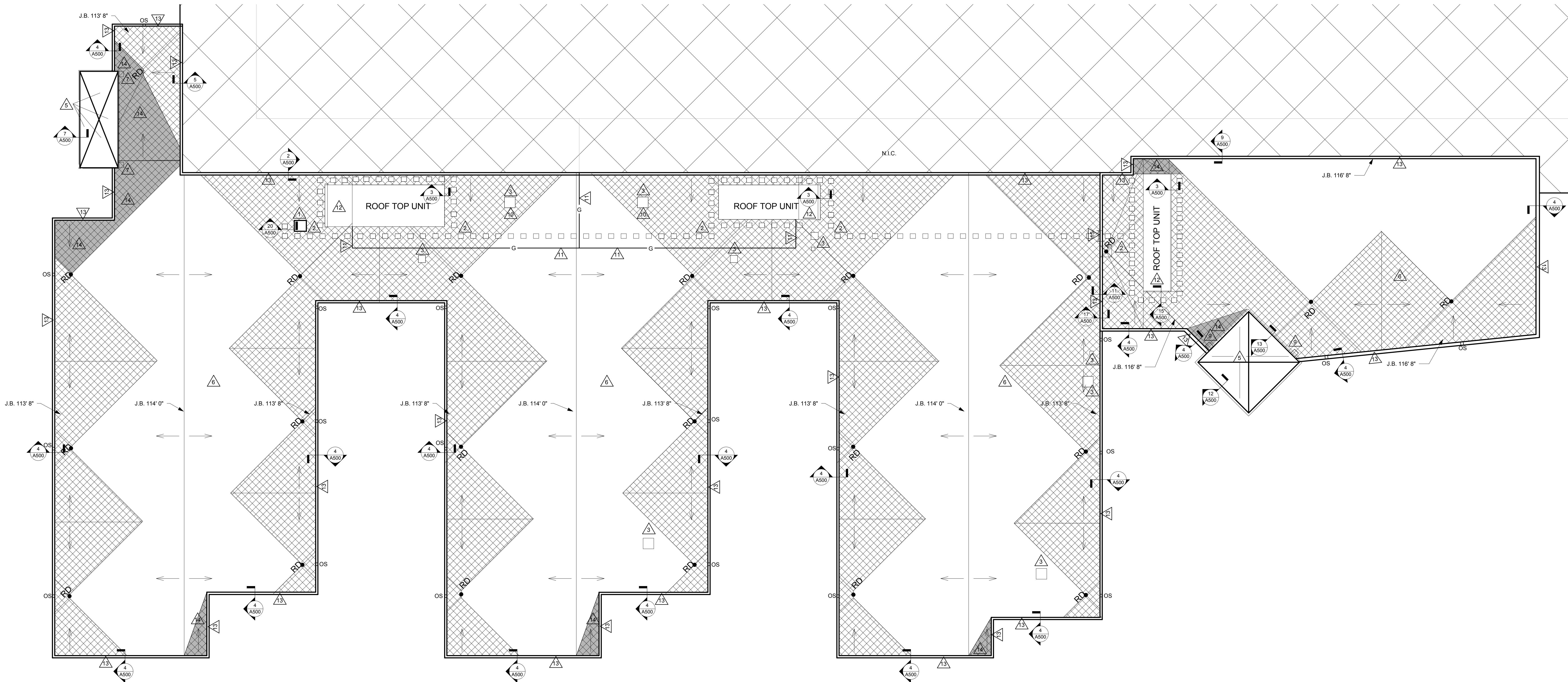

1 ROOF PLAN - NORTHWEST

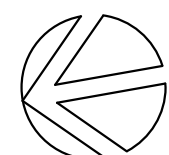

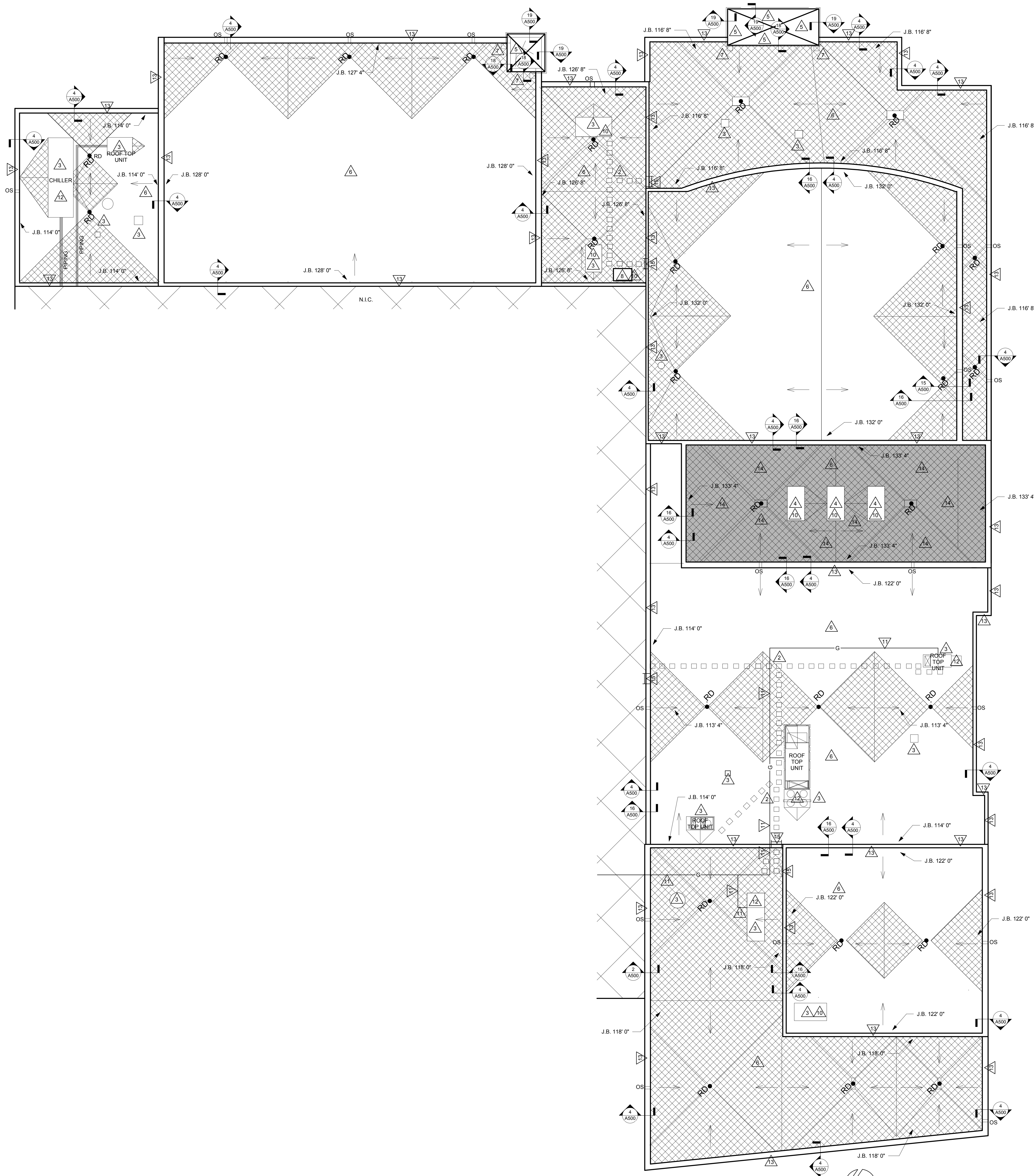

1 ROOF PLAN - SOUTH

GENERAL ROOF NOTES:
A SEE ROOF SYSTEM NOTES FOR MINIMUM AND AVERAGE INSULATION VALUES.
B ROOF EQUIPMENT SHOWN IS GRAPHIC ONLY. FIELD VERIFY CONDITIONS.
C ALL METAL ROOF AND FLASHING, SHALL MEET CURRENT SMACNA REQUIREMENTS AND MANUFACTURER'S SPECIFIED WARRANTY.
D WHERE MEMBRANE IS SHOWN OVER TOP OF WALL EXTEND DOWN, OPPOSITE SIDE AND SECURE TO BLOCKING.
E TOP OF WALL BLOCKING SHOWN IS GRAPHIC. PROVIDE BLOCKING THAT SHALL BE ANCHORED TO WALL BELOW AS RECOMMENDED BY ROOFING SYSTEM MANUFACTURER TO WITHSTAND WIND UPLIFT. AS STATED IN CODE. TOP OF WALLS SHALL SLOPE TOWARDS ROOF.
F INSTALL BOND BREAK BETWEEN ALL WOOD BLOCKING AND CMU OR CONCRETE.
G PROTECT LAWN, PAVEMENT, AND ALL OTHER EXISTING SITE CONDITIONS. CONTRACTOR RESPONSIBLE FOR ANY DAMAGE TO THESE ITEMS.

ROOF EQUIPMENT LEGEND:
CONTRACTOR TO VERIFY ALL EXISTING ROOF PENETRATIONS
EXISTING EXHAUST/INTAKE VENT HOOD/ HVAC UNIT
EXISTING AIR INTAKE/EXHAUST VENT/ PLUMBING VENT
RD = EXISTING ROOF DRAIN
EXISTING TAPERED INSULATION AREAS
OS EXISTING OVERFLOW SCUPPER
J.B. JOIST BEARING

KEY NOTES ROOF
1 EXISTING ROOF ACCESS HATCH 20A500
2 EXISTING 24" X 24" WALKING PAVERS. SALVAGE TO REINSTALL OVER MEMBRANE.
3 EXISTING ROOFTOP HVAC UNIT CURB DETAIL 3A500
4 EXISTING SMOKE HATCH. REMOVE TERM BAR AND MEMBRANE FLASHING. INSTALL NEW MEMBRANE FLASHING AND CONT. TERM BAR AROUND HATCH.
5 SHINGLED HIP ROOF. REMOVE SHINGLES. INSTALL WATERPROOF MEMBRANE AND SHINGLES. MAINTAIN EXISTING ROOF EDGE, FASCIA, AND FLASHINGS.
6 REMOVE BALLAST, MEMBRANE, AND PARAPET COPING FLASHING AT AREAS RECEIVING NEW MEMBRANE. INSTALL FULLY ADHERED SINGLE MEMBRANE OVER NEW 1/2" MECHANICALLY ATTACHED POLYISOCYANURATE INSULATION OVER THE EXISTING 4" OF EPS INSULATION. (COVER BOARD REQUIRED FOR 30 YEAR ALTERNATE). TAPERED INSULATION INDICATED BY HATCHED AREAS.
7 SALVAGE AND REINSTALL SPLASH BLOCKS AT DOWNSPOUT
8 SHEET METAL CURB CAP
9 NEW CONCRETE SPLASH BLOCKS
10 REMOVE EXISTING SMOKE HATCH. RAISE HATCH ROOF CURB BY MINIMUM OF 6 INCHES. FLASH AND REINSTALL HATCH AND PAINT. COORDINATE ELECTRICAL AND FIRE ALARM DISCONNECT/RECONNECT.
11 PAINT EXISTING GAS PIPING. COVER ROOF/ SUPPORTS TO PROJECT FROM PAINT DRIPPING
12 AT ALL ROOF TOP UNITS: MECHANICAL EQUIPMENT RAISE ROOF CURB BY MINIMUM OF 3 INCHES. ROOFING CONTRACTOR TO CONTRACT DIRECTLY WITH MECHANICAL AND ELECTRICAL CONTRACTOR FOR DISCONNECT AND RECONNECT HVAC EQUIPMENT THAT IS REMOVED FROM CURB. DISTRICT HAS EXISTING RELATIONSHIP WITH ADVANCED COMFORT SPECIALISTS, LLC. CONTACT TOM LEE 608-783-2268.
13 NEW PREFINISHED METAL CAP FLASHING AROUND ENTIRE PERIMETER OF RE-ROOF AREA. REFERENCE SECTION CUT DETAILS.
14 ADD ADDITIONAL 1/2" PER FOOT TAPERED INSULATION IN HIGHLIGHTED AREA TO IMPROVE DRAINAGE
15 REINSTALL EXISTING ROOF ACCESS LADDER

ARCHITECTURE
ENGINEERING
INTERIOR DESIGN

HSR ASSOCIATES INC.
100 MILWAUKEE STREET
LA CROSSE, WISCONSIN
PHONE: 608.784.1830
FAX: 608.782.5844
www.hsrassociates.com

Consultant:

Project Title:
LA CRESCENT-HOKAH PUBLIC SCHOOLS
LA CRESCENT HIGH SCHOOL PARTIAL REROOF

Project Location:
1301 LANCER BLVD
LA CRESCENT, MN, 55947

Sheet Title:
ROOF PLAN (SECTION B)

HSR Project Number:
18068

Project Date:
02-21-19

Drawn By:
HLH

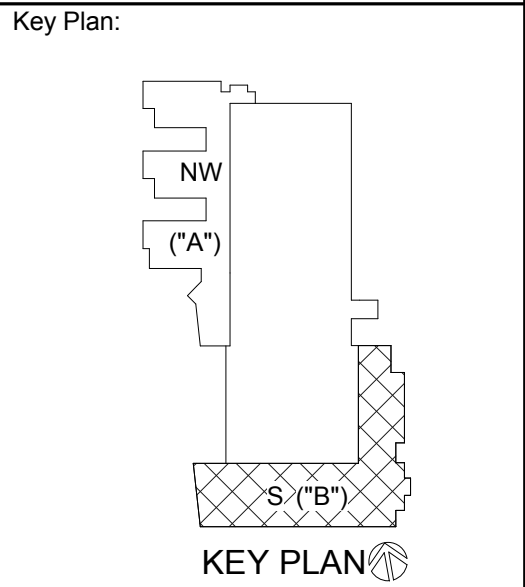

Revisions:		
No.	Description	Date
A3	ADDENDUM 3	03-12-19

Graphic Scale:
VARIES

Last Update:
3/12/2019 1:39:42 PM

A122R